



SM SERIES

SOFT LED MODULE DESIGN

LED solution

Starview SM Series adaptive LED tile allows for more creativity than ever before. Its radical lightweight design eliminates any traditional display screen component: no shader, no perforations, nothing to interfere with the viewing experience. Its light weight and ability to curve, bend, fold and attach to virtually any surface makes it perfect for those installations that call for a non-traditional LED solution.

FEATURES

1. SM series is available in SM-1.2, SM-1.5, SM-1.6, SM-1.8, SM-2.0, SM-2.5, SM-3.0 and SM-4.0
2. Good flexibility, can be curved freely
3. Make a customized personalized design
4. Adapt to more complex environments and better visual angles
5. Use the Chip LED with two options like SMD Kinglight or Nationstar
6. Soft frame is insulation, big magnetic force, good flatness
7. Allow creating Module video wall up to 360 curves

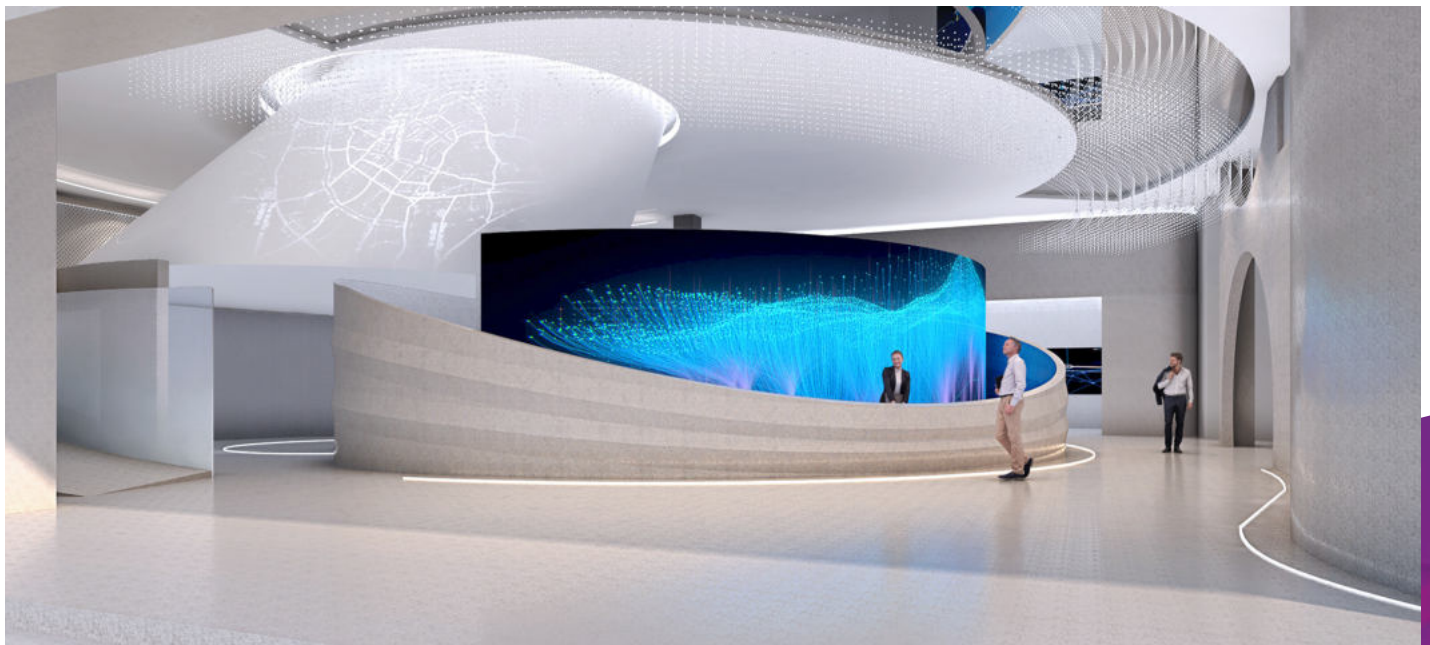



MAGNETIC

The slim and lightweight magnetic module can fit any design and adhere to any custom frame. It requires very little space for wiring and mounting.

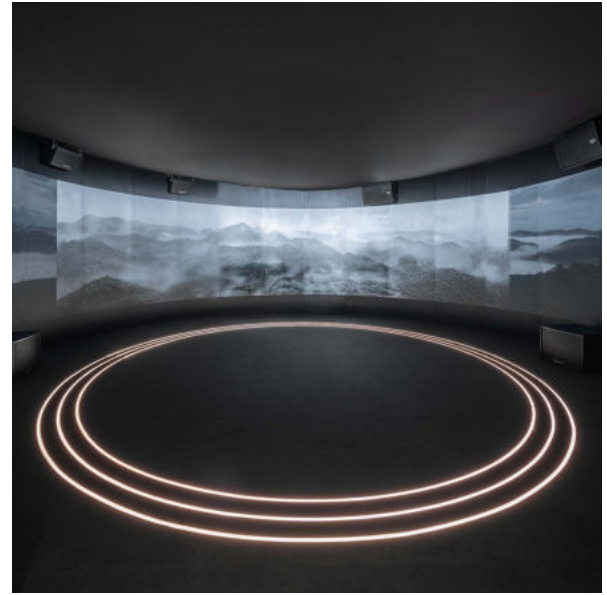

CUSTOM FRAMES

Starview SM specific framing structure is designed and manufactured to accomplish your unique design and deployment.



GOOD FLEXIBILITY

Module with small-unit and flexible design, makes possibility of more complicated shapes for the video show.



LARGE VIEW ANGLE

Make every viewing angle ideal, ensuring color and image size are always standard and vivid.

Technical specifications

SM SERIES

Model	SM-1.2	SM-1.5	SM-1.6	SM-1.8	SM-2.0	SM-2.5	SM-3.0	SM-4.0
Pixel Pitch	1.25 mm	1.579 mm	1.667 mm	1.875 mm	2.0 mm	2.5 mm	3.0 mm	4.0 mm
Pixel Density (pixels/m ²)	640,000	409,600	360,000	284,444	250,000	160,000	111,111	62,500
Pixel Configuration	SMD1212 Kinglight/ SMD1010 Nationstar, RGB 3-in-1	SMD1212 Kinglight/ SMD1010 Nationstar, RGB 3-in-1			SMD1515 Kinglight, RGB 3-in-1		SMD2121 Kinglight, RGB 3-in-1	
Chip of LED	Kinglight LED or Nationstar LED (Option)							
Module Resolution (W x H)	160x120 pixels	128 x96 pixels	144x72 pixels	128x64 pixels	120x60 pixels	96x48 pixels	80x40 pixels	60x30 pixels
Single Module Size (W x H)	200x150 mm	200x150 mm	240x120 mm					
Single Cabinet Size (W x H)	480 (720mm) x 1200mm (Customize)							
Cabinet Material	Slim Curvable Steel Cabinet							
Module Resolution (W x H)	ICN 2065			ICN 2153			ICN 2038s	
Power Supply	Meanwell/ G-energy Power							
Best View Distancing	1.25 - 200m	1.5 - 200m	1.6 - 200m	1.8 - 200m	2.0 - 200m	2.5 - 200m	3.0 - 200m	4.0 - 200m
Vertical Viewing Angle	140° (Standard LEDs Viewing Angle)							
Horizontal Viewing Angle	160° (Standard LEDs Viewing Angle)							
Brightness	800 nits							
Brightness Adjustable	Manual: 256 levels; Auto: 8 levels							
Contrast Ratio	3000 : 1							
Refresh Rate	3840Hz (Adjustable)							
Display Colors	10 bit (1.07B colors)							
Color Temperature	3000 ~ 12000°K (Adjustable)							
Scanning mode	1/48	1/48	1/36	1/32	1/30	1/24	1/20	1/15
LED Lifetime	> 100,000hrs Typ							
Protection	IP33							
Defect Rate	≤ 0.0002							
Operating Temperature	-30° to 60°C							
Operating Humidity	10% ~ 95% (RH)							
MTBF	> 100,000hrs							
Control Distance	120m (CAT6); Optical fiber: 500m - 10km							
Line Voltage	AC110 ~ 240V @ 50/60Hz							
Power Consumption	Max: 556 W/m ² ; Average: 198 W/m ²							

For technical or sales support, please visit:

www.starviewint.asia

Performance specifications are typical. Due to constant research, specifications are subject to change without notice. For the most up-to-date specifications, please contact an authorized Starview representative.

For assistance with confirming the Jurisdiction & Classification of Starview Asia products, please contact info@starviewint.asia

Copyright © 2025 STARVIEW ASIA. All rights reserved.
Australia Headquarters: Level 40, 140 Williams Street, Melbourne VIC 3000, Australia