

LED MODULE

The LED display, which expands by attaching a module to the cabinet, is easy to use and install, such as wall-mounted, mounted, and stand-type, and maintenance and module replacement are simple.

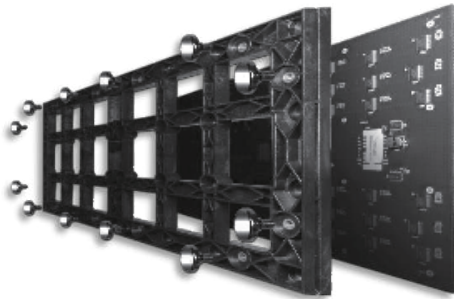

OUTDOOR LED DISPLAY TECHNOLOGY

Starview brings LED video to the next level with its standard package LED display solution. Designed for premier applications that require the highest image quality at the closest viewing distances, this product takes advantage of 3-in-1 SMD (surface-mount device) LED technology to produce exceptional brightness, unsurpassed viewing angles and incredible picture detail. Starview can provide flexible solutions to fit customers' unique display needs, right down to the LED.

SA-KLED SERIES

OUTDOOR LED VIDEO WALL

DESCRIPTION

Starview SA-KLED Series outdoor fine pitch LED Video Wall displays offer seamless, front-service, high resolution visual experiences. Available in pixel pitches as small as 2.5mm, infinite expansion and stable configuration method different from the limited existing LCD screen configuration products. With a display capable of expressing various images, it is a multi-display that can be used efficiently in the desired place.

FEATURE

- 2.5/ 3.0/ 4.0 mm LED Pitch
- Outdoor 4500 ~ 5000 cd/m² brightness
- High refresh rate & gray scale to realize clear and smooth images
- Durable over 100,000 hours of LED Lifetime (semi-permanent)
- Partial repair is possible with the separation method of LED module
- It realize perfect color adjustment with dedicated calibration tool
- Thin and light cabinet
- IP Rating IP65
- 16:9 video, curve screen, Certified product suitable for various applications such as panorama.



INSTALLED FOR MANY DISPLAY APPLICATIONS

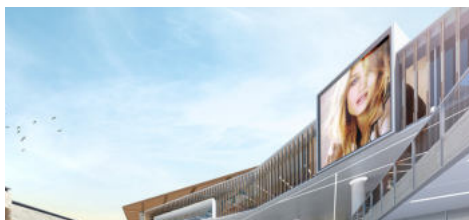

Technical specifications

SA-KLED SERIES OUTDOOR

Model	SA-KLED-2.50	SA-KLED-3.00	SA-KLED-4.00
LED Type	Kinglight SMD1415	Kinglight SMD1515	Kinglight SMD1921
Pixel Pitch	2.5 mm	3.076 mm	4 mm
Cabinet Resolution	384 x 384 pixel	312 x 312 pixel	240 x 240 pixel
Cabinet Size (W x H) (Customize)		960 x 960 mm	
Cabinet Material		Die Casting Aluminum	
Cabinet Weight		40 Kg	
Modules/Cabinet		18 pcs	
Module Size		320 x 160 mm	
Module Resolution (W x H)	128 x 64 pixel	104 x 52 pixel	104 x 52 pixel
Pixel Density	160,000	105,625	62,500
Module Weight		0.6 Kg	
Birghtness (cd/m ²)		4500 - 5000 cd/m ²	
Contrast Ratio		≥5000:1	
Scan Mode		1/16	
View Angle (H/V)		170°/170°	
Min. Viewing Distance	2.5 m	3.076 m	4 m
Display Color		14 bit (4,398 billion)	
Color Temperature		3200 - 12000 adjustable	
Refresh Rate		≥3840 Hz	
Power Supply		AC100 ~ 240V, 60Hz	
Power Consumption (Max. / Ave.)		850/280 W/m ²	
MTBF		>10,000 hours	
LED Lifetime, Typical		≥100,000 hours	
IP Rating (Front/Rear)		IP65	
Maintenance Method		Back	
Storage Temperature	-20° to 50° C		-20° to 80° C
Storage Humidity		10 - 95% relative humidity non-condensing	
Operating Temperature	-20° to 50° C		-20° to 80° C
Operating Humidity		10 - 95% relative humidity non-condensing	

Specifications subject to change. For the most up-to-date specifications, please visit starviewint.asia

For technical or sales support, please visit:
www.starviewint.asia

Performance specifications are typical. Due to constant research, specifications are subject to change without notice. For the most up-to-date specifications, please contact an authorized Starview representative.

For assistance with confirming the Jurisdiction & Classification of Starview Asia products, please contact info@starviewint.asia

Copyright © 2025 STARVIEW ASIA. All rights reserved.
Australia Headquarters: Level 40, 140 Williams Street, Melbourne VIC 3000, Australia